

# HEATWAVE PLAN

100 M

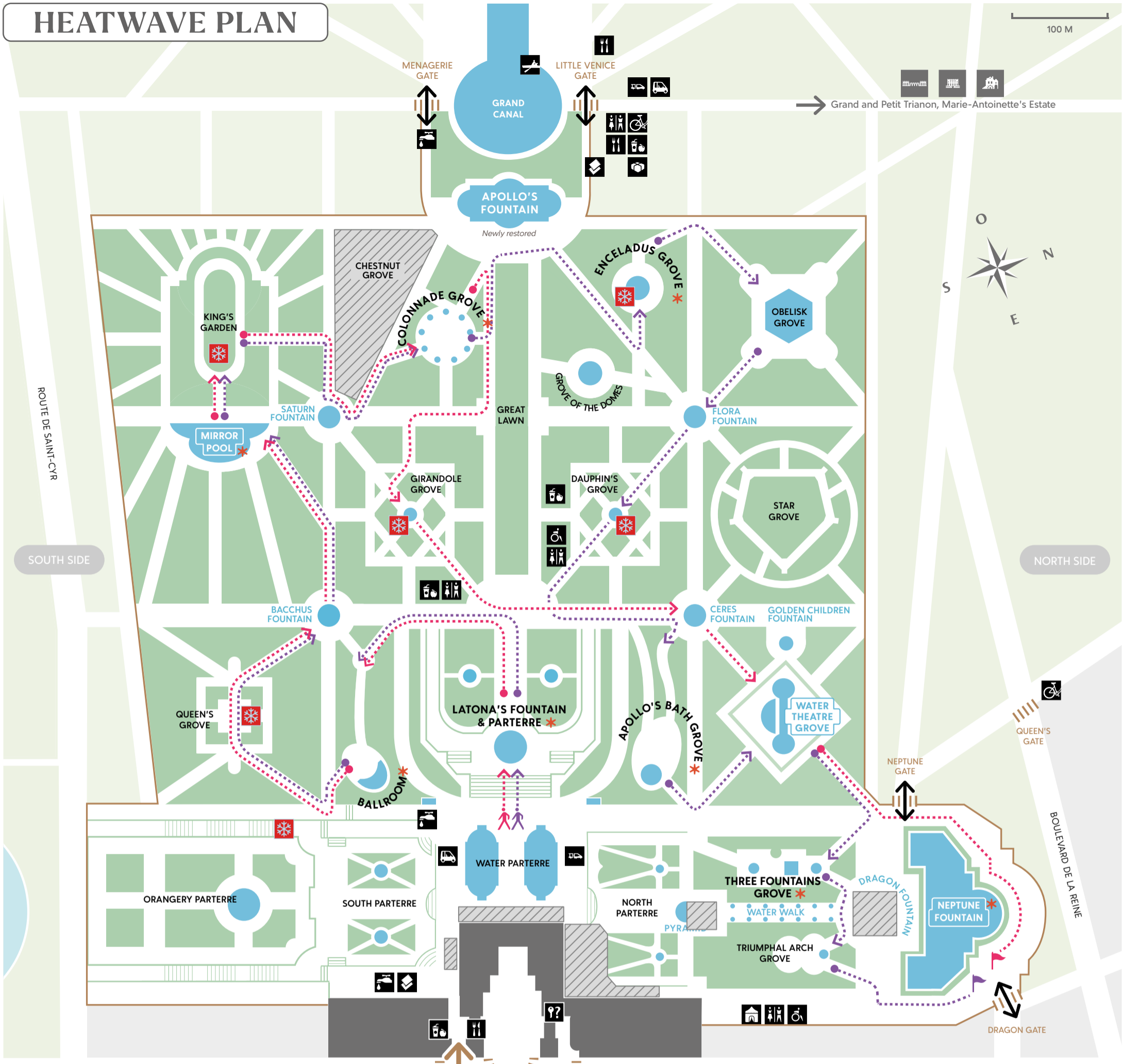

## TODAY IN THE GARDENS

**9 am > 19 pm:** Groves exceptionally open  
**10 am > 19 pm:** Musical displays  
**10:30 am > 17:30 pm:** Water displays

### FONTAINES AUTOMATIQUES

**ALL DAY**  
 Every 10 minutes: mirror Pool  
 Every 15 minutes: neptune Fountain

### HISTORICAL FOUNTAINS

**MORNING**  
**10:30 am > 12 am:** Grand perspective  
**10:30 am > 11:30 am:** South side groves and fountains\*

### HISTORICAL FOUNTAINS

**AFTERNOON**  
**2pm > 2:30pm & 3pm > 3:15pm & 4:45pm > 5pm:** Grand perspective  
**2:30pm > 3:15pm & 4pm > 4:45pm:** All groves and fountains  
**5:20 pm > 5:30 pm:** Neptune Fountain.

\*Ballroom, Colonnade, Girandole and Chesnut Grove, Mirror Pool, Bacchus and Saturn Fountains.

## SUGGESTED WALKS

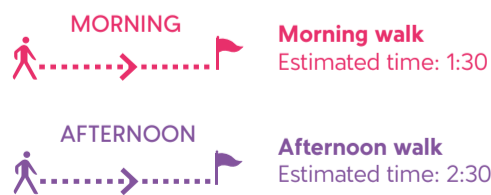

## \* GROVES & FOUNTAINS NOT TO BE MISSED

## ❄️ COOLING AREAS

[CLICK ON THIS LINK](#)

to see the watering schedules updated in real time for historical fountains.

- Stairs
- Musical gardens ticket office
- Information Chateau de Versailles ticket office
- Reception hall (schools)
- Entrance / Exit
- Free toilets
- Facilities for visitors with reduced mobility
- Souvenirs Book shop
- Mini-train: circuit to Trianon
- Electric cars
- Bicycle rental
- Rowing boats
- Restaurants
- Snacks
- Lost and found
- Drinking water
- Works

## NOTICE TO VISITORS

**Keep your ticket with you and show it at control points.**  
 No picnics are allowed inside the paying area.  
 It is forbidden to walk or sit on lawns or to lean on or touch statues.  
 The fountains' water is non-drinkable. Bathing is prohibited.  
 Please observe instructions given by hospitality staff.